



EarthH

VENUE INFORMATION 2019-2020

ADDRESS

13 – 15 Stoke Newington Road
London
N16 8BH

Tel: 020 7422 7505

CAPACITY

Concert Hall 1250 including guests

Theatre 680 including guests for fully seated

Theatre 750 including guests for seated/standing room at the front

Earth Kitchen 300 including guests (afterparties available free of charge if open to public, private parties cost available on enquiry)

CONTACTS

Dan Monsell Live and Club Booker dan@earthackney.co.uk – 07866670791

Bay Sisouphanh – Private Hire and Corporate Booker – bay@villageunderground.co.uk – 07557 731797

Harry Peters – Ops and Production – harry@villageunderground.co.uk – 07545 373321

Greg Phizacklea – Venue / Production Manager- greg@earthackney.co.uk - 07790 181585

Josh Watts – DPS / Operations Manager - josh@villageunderground.co.uk - 07446 144212

To contact on shift Manager please email: dutymanager@earthackney.co.uk

Or call on: 07543838475

TICKETING

We have NO daytime walk-in box office. Online www.earthackney.org

Tickets will be sold through our See account and all tickets are scannable on entry. The venue requires a minimum of a 50% allocation of the saleable capacity.

AGE RESTRICTIONS

Concert Hall 16+ (Each under 18's must be accompanied by a responsible adult)

Theatre 16+ (Each under 18's must be accompanied by a responsible adult)

Club Events (running past 11pm) 18+

FACILITIES

Production Office

Location: On the ground floor shared with main office. Wireless internet available.

No outside line available in dressing rooms.

DRESSING ROOMS

Location: Off stage left on the ground floor. Off stage right in the theatre.

1st Floor dressing room has its own shower and toilet.

2nd Dressing room available in downstairs space if needed.

SPECIAL EFFECTS

Smoke & haze may be used freely. Pyrotechnics are not permitted. Lasers may only be used by prior arrangement a minimum of 4 working weeks prior to the performance

VENUE INFORMATION 2019-2020

date(s). We will require both method statement and risk assessments for our records. All operators must be deemed competent. We will have to consult Hackney Council for consent (for the above).

CREW

Provided by promoter, you must inform us and ensure that the supplier is a recognised and reputable company with the correct insurances, training and appropriate PPE. In House crew can be arranged for £60ph per person for a minimum 5hr call

FOS BARRIER

In-house ped barrier. 'Mojo' style can be hired if needed with no cost to the promoter.

TOWELS

Promoter to supply

LOAD IN MAP

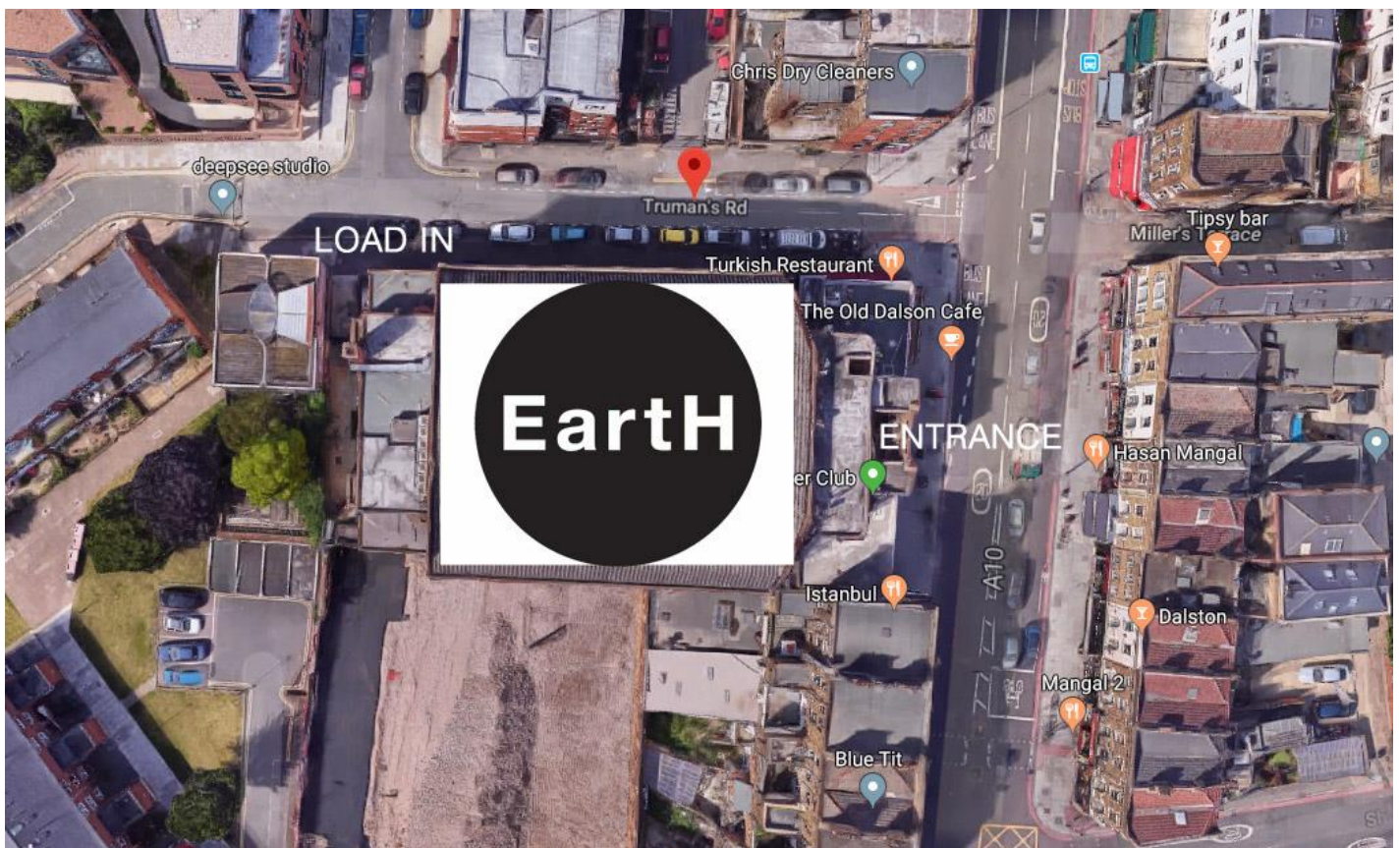

LOAD IN

Load in address. Parking located at the rear of the venue for pre show, entrance on Trumans Road located at the rear of the venue.

Load in details: Load in through Trumans Road Fire exit. 10 steps down to venue
Theatre: Load in through Trumans Road Fire Exit 15 steps up to venue

VENUE INFORMATION 2019-2020

Load in time: 1pm – earlier by arrangement @ additional cost

Parking details: Trumans road if bay is available and subject to parking rates and tickets.

Alternatively arrange for bay suspension through the council - <https://hackney.gov.uk/suspensions> please do this at least 1 month prior to performance to ensure this is done in time.

Night liner parking ExCel Centre (E16 2BU) is a good alternative for this £30 a day, 24 hour access, but no shore power - 02070694568. Tower Hill coach & car park (EC3R 6DT), 10 minute drive from the venue, but no power, no reservations and £72 a day.

No load in before 1pm.

If you require access before 1pm please contact us in advance to arrange this. This may incur an extra charge.

LOAD OUT MUST BE AS QUIET AS POSSIBLE AT ALL TIMES, PLEASE RESPECT OUR NEIGHBOURS. WHERE POSSIBLE PLEASE ARRANGE FOR NEXT DAY COLLECTION

LOAD OUT MUST BE OUT THE FRONT OF THE BUILDING

Load-in is street level, backstage left.

Metres / Feet

Width: 1.52m / 5'

Height: 2.13m / 7'

STAGE

Stage dimensions / Staging:

Concert Hall

Metres / Feet

Depth: 6m / 20'

Width: 10m / 33'

Width between truss: 10m / 32' Height: 3m / 9.5'

Clearance to Truss 2.86m / 9'

Theatre

Metres / Feet

Depth: 7m / 21'

Width: 20m / 66'

Width between truss: 6m / 19' Height: 6m / 19'

Clearance to Truss 4m / 12'

An additional 2x 8'x4' Litedeck are available for use as risers.

FOH POSITION

Concert Hall

Metres / Feet

Distance from Stage: 15m / 45'

Theatre

Metres / Feet

Distance from Stage: 6m / 19'

VENUE INFORMATION 2019-2020

SOUND, LIGHTING & POWER FOR IN-HOUSE PRODUCTION

THEATRE VENUE PA SPEC

L-ISA frontal system

35 L'Acoustics Kara (equally split into 5 arrays of 7 speakers)

4 L'Acoustics KS28 (flown in an end fire array configuration)

L-ISA surround

12 L'Acoustics Syva (on side and rear walls)

8 L'Acoustics X8 (flown as overheads)

Front Fills

10 L'Acoustics X8

FOH Console & L-ISA control

1 DiGiCo SD12

1 D2 Rack (48 input, 16 output + AES)

1 Laptop for L-ISA controller

1 Laptop for LA-Network Manager

Mics, DIs & Stands

2 Shure Beta 52A

2 Shure Beta 91A

2 Shure Beta 57A

2 Beyerdynamic M201

6 Sennheiser e604

2 Sennheiser e906

2 Beyerdynamic M88

4 Sennheiser MD421

10 Shure SM58

10 Shure SM57

4 Shure KSM137

4 Audio Technica 4050

1 Electrovoice RE20

8 Radial J48 Active Mono DI

2 Radial J48 Active Stereo DI

20 K&M Tall boom Microphone stand

16 K&M Short boom

CONCERT HALL PA SPEC

FOH system

8 L'Acoustics KARA

2 L'Acoustics SB18

4 L'Acoustics SB28

4 L'Acoustics LA8 amp

Delays

4 L'Acoustics ARCS WIDE

FOH Console

1 DiGiCo SD12

1 D2 Rack (48 input, 16 output + AES)

Monitor Console

1 DiGiCo SD12

1 D2 Rack (48 Input, 24 output)

Monitor System

10 L'Acoustics X15 HiQ

2 L'Acoustics SB18

5 L'Acoustics LA4X

Multi core & Split System

1 12-pair multicore + 4 Cat6 & 4 BNCs

1 V4 splitter (48 channels)

5 12- channel satellite box

2 12- channel satellite loop box

DJ Equipment

4 CDJs Nexus

1 DJM900 Nexus

1 Xone92

2 Technics 1210s

POWER

Theatre 1 63 3 PHASE OUTLETS TO 32/16/13
SHARED AUDIO AND LIGHTING POWER

Concert Hall 1 63 3 PHASE OUTLETS TO 32/16/13
SHARED AUDIO AND LIGHTING POWER

VENUE INFORMATION 2019-2020

LIGHTING SPEC THEATRE

Fixture no.	Fixture	Channel mode	Dmx (uni-addr)	Notes
1	VL3000 Spot	28 Channel	1-001	
2	VL3000 Wash	16 Channel	1-030	
3	VL3000 Wash	16 Channel	1-050	
4	VL3000 Spot	28 Channel	1-101	
5	VL3000 Spot	28 Channel	1-131	
6	VL3000 Spot	28 Channel	1-161	
7	VL3000 Spot	28 Channel	1-191	
8	VL3000 Wash	16 Channel	1-301	
9	VL3000 Wash	16 Channel	1-321	
10	VL3000 Wash	16 Channel	1-341	
11	VL3000 Wash	16 Channel	1-361	
	Source Four			
12	Par	1 Channel	1-502	House lights, addressed in pairs/fours.
	Source Four			House lights, addressed in pairs/fours.
13	Par	1 Channel	1-503	House lights, addressed in pairs/fours.
	Source Four			House lights, addressed in pairs/fours.
14	Par	1 Channel	1-504	House lights, addressed in pairs/fours.
	Source Four			House lights, addressed in pairs/fours.
15	Par	1 Channel	1-505	House lights, addressed in pairs/fours.

Avolites Pearl Desk

Earth Kitchen PA spec

PA/Speakers

N. d&b Y SUB - Sub Bass Cabinet (NLT4) x 2

R. d&b D12 Amplifier (EP5) x 2

d&b Q7 - Speaker Cabinet (EP5) 2

13amp plug to powercon Mains Cable 2

13a plug - 16a - 32a adapter cable 1

16a to 13a Mains Power Board 1

32a single phase Mains Cable 10m

32a single phase Mains Cable 20m

Mics/Stands/Desks/Lights

Shure SM58 LC 8x Shure SM58 LC

4x Shure SM57 LC

1x AKG Drum Set Session (full drum set)

5x the sssnake SK233-1,5 XLR Patch

1x pro snake 80831-15 XLR Multicore 15m

3x Behringer F1220D Eurolive

1x Behringer Xenyx QX2442USB

9x Tall Mic Stand

1x Peavey Max 110

3x Stairville PDC3CC DMX Cable 5,0 m 3 pin

2 x Stairville PDC3CC 3 pin DMX cable 3.0m

9x the sssnake DMX-Cable 300/3

5x the sssnake Powercord UK C13 1,5m

VENUE INFORMATION 2019-2020

NOISE MANAGEMENT

DB limit at FOH is 100 dBA 15min LAeq.

MERCHADISE:

Self vend. Venue can arrange staff on request at cost @ £60/person for 5 hr minimum
The merch fee is 10% in the Concert Hall and currently no fee upstairs in the theatre.
10% Merch Fee Payable to Duty Manager on the night.

DOOR TIMES: 7pm for week shows, 9pm for clubs

CURFEW: Licensed until 12am Monday to Thursday 2am Friday and Saturday

DOOR STAFF: Promoter to provide at least 1 guest list and 1 ticketing staff for live gigs.

Venue can provide on request (£60 per person minimum 5hr shift £12.50 thereafter) Venue will provide 1 x door staff for any night venue have allocation.

If tickets are being sold on the door please provide 2 door staff 1 for cash and ticket list's / scanners and one for Guest list.

STAGE HANDS: £60 per load in or load out 5 hour minimum call 12.50/hr there after

Hotels: Premier Inn Hackney, The Hoxton Shoreditch, Ace Hotel Shoreditch

CROWD BARRIERS

If crowd barriers are deemed necessary for a show these will need to be hired in. Venue will cover this cost.

FLYING / RIGGING

Please email greg@earthackney.co.uk for further information

All rigging/flying requests must be agreed 1 week before show day. It is a fixed rig and any movement of lights or truss will incur costs.

Please first check with Greg Phizacklea or Harry Pete

VENUE PLANS

CONCERT HALL

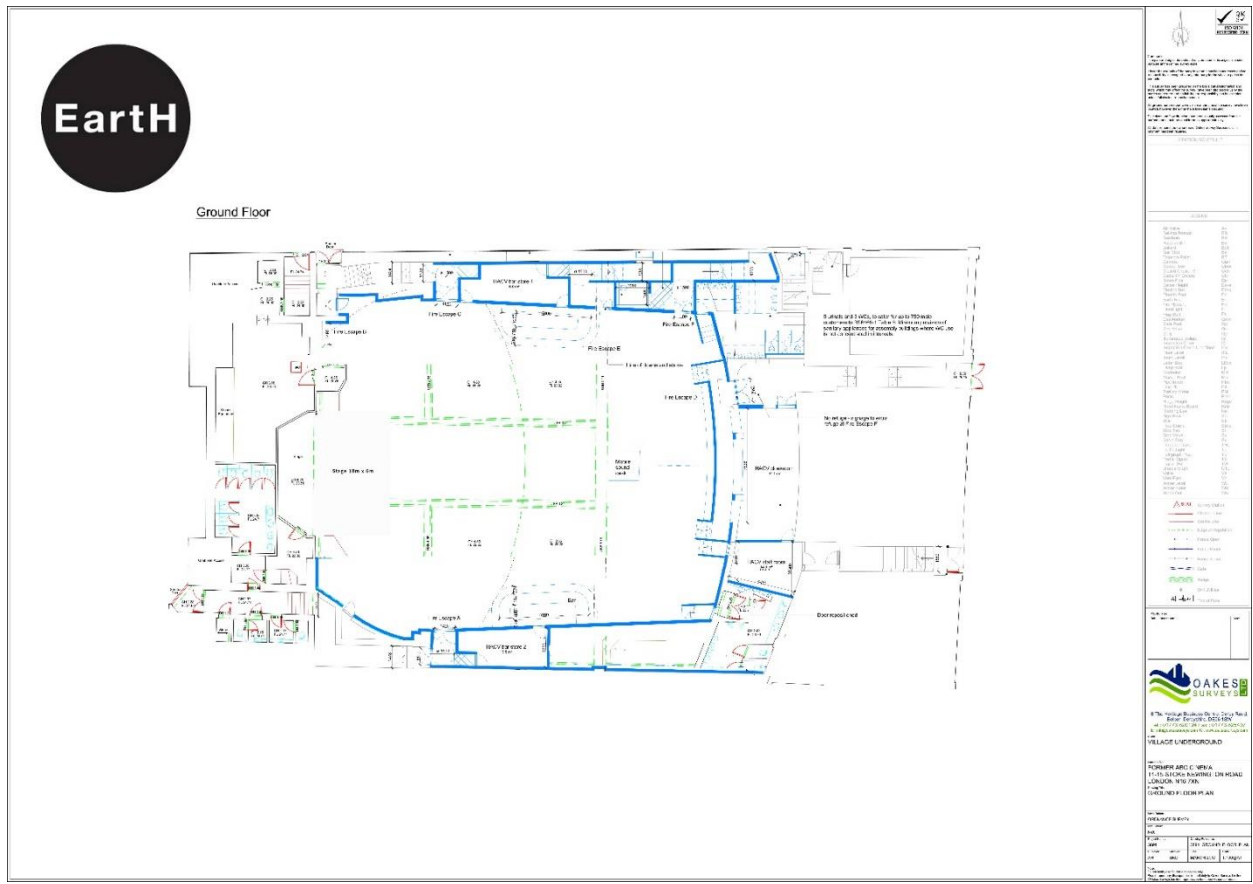

THEATRE

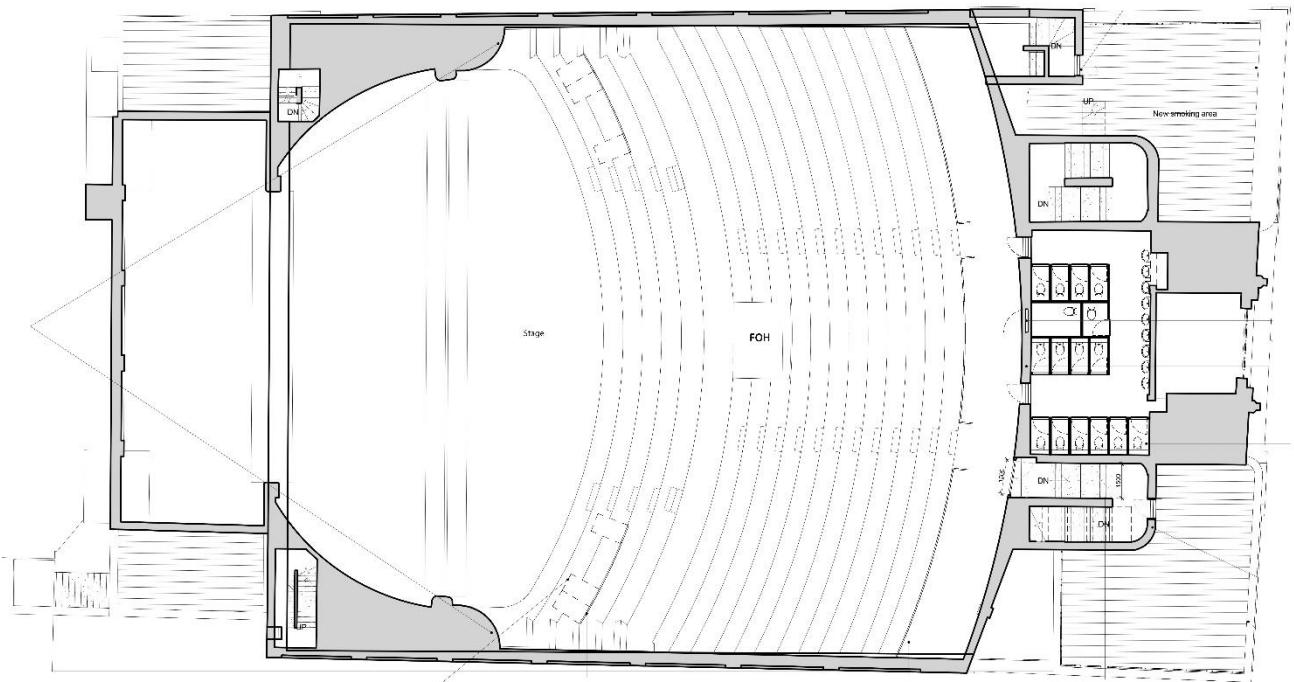

The Theatre